

Shawna Stone
6620 Fincrest Dr
Colorado Springs, CO
80923

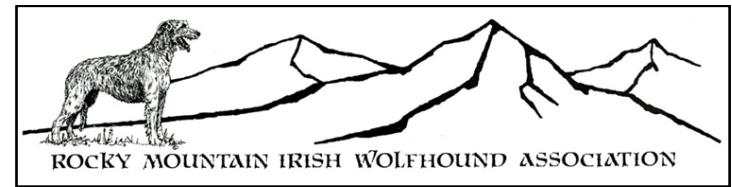

PREMIUM LIST

This premium available via email from show secretary: AZenDogTraining@gmail.com

Early entries close on November 12, 2019 at 5:00 p.m.

at the Field Trial Secretary's address

Day of trial entries close at **8:00 am** the day of the trial at the FTS desk.
(Substitutions by the same owner will be allowed by Roll Call the day of the trial)

ASFA SANCTIONED

2019 ASFA 2 Day Region 3 Invitational

November 16 & 17th

***** BEST IN EVENT will be awarded on Sunday. *****

Falcon Institute for Advanced Coursing Studies
16380 Falcon Highway
Peyton, Colorado 80831-7993

Entry Fees:

EARLY ENTRY FEES: \$22.00 for first entry; \$19.00 each additional hound with same owner.

Breeder, Kennel & Bench: \$10.00 a unit.

Late & Day of Trial entry: \$30.00

Any hound that has earned at least one ASFA point is eligible to enter. For a Provisional breed to be eligible, the entered hound must have received a placement, with competition. All points or placements must be earned by the closing date of the event. Any hound entered in the Singles Stake does not need prior ASFA experience. AN eligible hound may be entered in any number of regional invitationals.

Payments via PayPal accepted

Please add \$2 to the entry fees and send to Treasurer@RMIWA.org

Send a copy of the PayPal receipt along with your entries to the Field Trial Secretary



Permission has been granted by the American Sighthound Field Association for the holding of this event under American Sighthound Field Association Rules and Regulations.

Audrey Silverstein, Chairman
ASFA Scheduling Committee

ROCKY MOUNTAIN IRISH WOLFHOUND ASSOCIATION



ROCKY MOUNTAIN IRISH WOLFHOUND ASSOCIATION

OFFICERS AND DIRECTORS

President: Denise Shorey Treasurer: Amy Solberg
 Vice President: Michelle Storer-Fujiwara Secretary: Shawna Stone
 Brd. of Dir.: Jody Bryan, Michael Hussey, Connie Smalley, Kim Underwood

ASFA Officers and Board Members:

President: Dean Wright; 1st VP: Greg Breitbach; 2nd VP: Tom Cigolle; Corr. Sec'y: Holly Hamilton;
 Rec. Sec'y: Ping Pirrung; Chief Financial Officer: Phil Fullam

Region 1 Dir: Jennifer Vookles Region 2 Dir: Jayme Jones
 Region 3 Dir: Dan Heidel Region 4 Dir: Gary Runyan
 Region 5 Dir: Trisha Borland Region 6 Dir: Lee Warden
 Region 7 Dir: Elaine McMichael Region 8 Dir: Kathy Sanders
 Region 9 Dir: Cathy Sanderson Region 10 Dir: Jennifer Gysler

JUDGES (AND THEIR ASSIGNMENTS)

Deann Britton – Aurora, CO
 Downing -Lucas, TX
 Mike Hussey – Elizabeth CO
 Phil Fullam – Rio Rancho, NM
 Pete Lowe – Falcon, CO
 Claudia Miller – Arvada, CO

OPEN - Any eligible sighthound, excluding ASFA Field Champions of record that has met ASFA Certification requirements.

FIELD CHAMPION - Any ASFA Field Champion

VETERAN : Any eligible hound whose age is at least six years, except Irish Wolfhounds whose age shall be at least five years, and Afghan Hounds, Rhodesian Ridgebacks, Salukis, and Whippets whose age shall be at least seven years. Points go toward V-FCh or V-LCM titles."

SINGLE STAKE: Any eligible sighthound including those disqualified to run in other stakes. Each hound runs alone. Not eligible for Best of Breed or Best in Field. Hounds are eligible to earn TCP and CPX titles from the Singles stake. Limited breeds are not eligible for these titles.

LIMITED - Any eligible sighthound of an eligible Limited stake that has met certification requirements. Not eligible to compete in Best of Breed or Best in Regional

BREEDER: For any breed which shall have, designated at the time of entry, two hounds bred by the same person or individual.

KENNEL: For hounds of any individual breed, an entry shall consist of two hounds designated at the time of entry in one of the regular stakes, being owned and kenneled by the same person or individual.

BENCH: For any eligible sighthound with proof on file with the ASFA of a conformation champion title from the AKC, CKC or both, or a conformation grand champion title from the UKC.

CONDITIONS OF ENTRY:

- All entries must be one year or older on the day of the trial.
- Stakes will be split into flights by public random draw if the entry in any regular stake is 20 or more.
- Bitches in season, lame hounds and hounds with breed disqualifications will be excused at roll call.
- Spayed, neutered, monorchid or cryptorchid hounds without breed disqualifications may be entered.
- Hounds with breed disqualifications are not eligible to enter
- Hounds not present at the time of roll call will be scratched.
- All hounds will run twice, in trios if possible or braces (except in the Single Stake), unless excused, dismissed or disqualified.

Certification runs will be available weather and equipment condition permitting and at the discretion of the field trial committee.

Please Contact Michael Hussey - Field Trial Chairman about Certification Runs

REFUND POLICY - Refunds will be allowed for lame hounds, bitches in season and breed disqualifications as determined at the trial inspection. Full refunds are allowed for entries cancelled **for any reason prior** to the **EARLY** entry closing date and time.

GENERAL INFORMATION and POLICIES: A penalty of \$5.00 will be assessed for any loose hound not competing in the course in progress. Battery powered continuous loop machine will be used. Lure will consist of white plastic strips or a combination of black and white plastic strips. Back-up equipment will be available. **BRING WATER AND SHADE FOR YOUR HOUNDS. Porta-potty on site. WARNING:** It is advised that all hounds entered be in top physical condition due to the altitude and rigorous conditions of the course. **ALL HOUNDS RUN AT THE OWNER'S SOLE RISK.**

COURSE PLAN: The RMIWA reserves the right to alter the course diagram **ONLY** as required by weather and/or field conditions on the day of the trial.

Saturday November 16th, 2019																		
	A	AZ	Ba	B	C	G	Ib	Ig	IW	P	R	S	SD	SI	SW	W	Sgl	Ltd
DB													X	X	X	X	X	X
JD	X	X	X	X									X	X	X	X	X	X
PF	X	X	X	X	X	X	X	X	X	X	X	X						
MH					X	X	X	X	X	X	X	X						

Sunday November 17th, 2019																		
	A	AZ	Ba	B	C	G	Ib	Ig	IW	P	R	S	SD	SI	SW	W	Sgl	Ltd
JD	X	X	X	X	X	X	X	X	X	X	X	X						
PF													X	X	X	X	X	X
PL	X	X	X	X	X	X	X											
CM								X	X	X	X	X	X	X	X	X	X	X

FIELD COMMITTEE

Field Chairmen Mike Hussey dinnree@skybeam.com
 Field Secretary Shawna Stone AZenDogTraining@gmail.com
 6620 Fincrest Dr, Colorado Springs, CO 720-290-6423

Lure Operators R Buhrdorf, D Heidel, C Sullivan, M. Hussey

Ribbons or rosettes will be offered for all placements.

First=Blue, Second=Red, Third=Yellow, Fourth=White,
 NBQ=Green Highest Scoring Single=Navy/Gold, Breeder= Rose,
 Kennel= Green Best of Breed=Purple/Gold, & Best in Event=Red,
 White & Blue.

STAKES OFFERED:

Saturday

Sunday

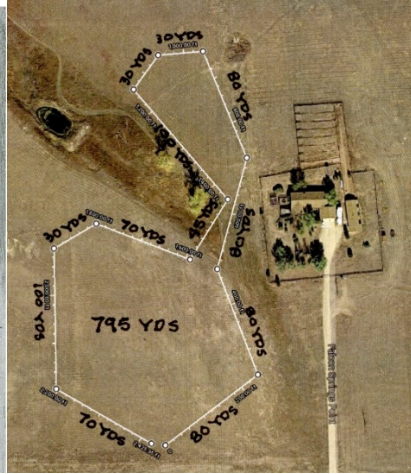
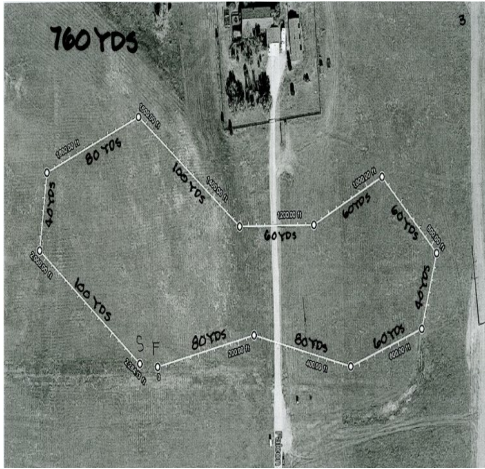

The following will accept guests with well-behaved dogs, and are in the Colorado Springs area: Comfort Inn 6450 Corporate Dr, 719-262-9000
 Ramada Inn, I-25 & Hwy 24, Exit 145 – 719-633-5541
 Howard Johnson, 8280 Hwy 83, Exit 150 – 719-598-6700
 Super 8 Colorado Springs, 719-597-4100
 Days Inn Colorado Springs, 719-266-1317
 Motel 6, 3228 N. Chestnut – 719-520-5400 (20 miles from site)
 Camping is available at the site \$15.00 a day. Must be self-contained.
 Falcon Meadow Campgrounds, 11150 Hwy 24, Falcon – 719-495-2694
 (Falcon is 5 miles west of the trial site)

Directions to Trial Site

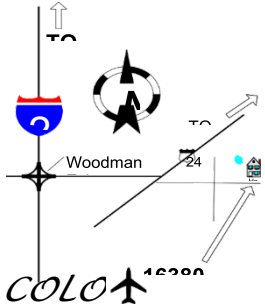

From I-25 North or South: Take Woodmen Road Exit and travel east to Highway 24. Turn Right on Highway 24 and then turn Left on Meridian. Go to stop sign and then Turn Left on Falcon Highway. Turn Left in drive way at 16380 Falcon Highway.

We will have food on site:

The Wolfhounds WaySide Cafe will provide a light breakfast and lunch for entrants.

Breakfast will be \$5 and Lunch will be \$10

Veterinarian in vicinity:

- Veterinarian –**Saturday** – Ponderosa Veterinary Clinic 6770 Foxtrot Lane Suit B 719-433-7671.
- **Sunday:** Powers Pet Emergency & Specialty, 5888 Tutt Blvd. 719-473-0482

INFORMATION/POLICIES

- Port-a-pottys on site.
- BRING WATER AND SHADE FOR YOUR HOUNDS.
- Due to dry conditions, smoking of any kind is prohibited on the field, Absolutely NO CAMP FIRES!
- PICK UP AFTER YOUR DOG AND YOURSELF!
- For further information contact: Shawna Stone (720)290-6423



ACCOMMODATIONS - EARLY RESERVATIONS ARE A MUST

**OFFICIAL AMERICAN SIGHTHOUND FIELD ASSOCIATION ENTRY FORM
2019 ASFA Region 3 Invitational**

****November 16, 2019****

Early entries close Tues. November 6, 2019 at 5:00 p.m.

\$22.00 for 1st dog, \$19.00 ea. add'l dog same owner. \$10.00 Non-Regular Stakes

Day of Trial entries close at Roll Call on the day of the trial, \$30.00 per dog.

Make checks payable in US funds to RMIWA and mail with entry to:

Shawna Stone 6620 Finecrest Dr, Colorado Springs, CO 80923

Fee Paid _____ The Field Secretary cannot accept conditional, unsigned, incomplete or unpaid entries; please check your completed entry carefully.

Breed:		Call Name:	
Registered Name of Hound:			
Stake: <input type="checkbox"/> Open <input type="checkbox"/> FCH <input type="checkbox"/> Veteran <input type="checkbox"/> Single <input type="checkbox"/> Limited		Additional Stakes <input type="checkbox"/> Kennel <input type="checkbox"/> Breeder <input type="checkbox"/> Bench	
Registration Number: (please write in registering body before number)			
<input type="checkbox"/> If possible, please separate my hounds		Date of Birth:	Sex: <input type="checkbox"/> Dog <input type="checkbox"/> Bitch
Name of actual owner(s):			
Address:		Phone:	
City:		State:	Zip:
E-mail (Optional)		(Optional) Region of Residence:	
Emergency Contact Name and Phone (Optional)			
<input type="checkbox"/> Check if this is the first ASFA trial for this hound. Attach a Hound Certification or waiver if entered in Open, Veterans, Limited.			
<input type="checkbox"/> Check if this is a first-time entry, a copy of the official Registration of this hound must accompany this entry unless NGA.			
<input type="checkbox"/> Check if any information has changed since the last ASFA trial entry. Regarding _____			
<input type="checkbox"/> Check if this hound has been dismissed within the last 6 trials entered. Must be marked in order to qualify for a "clean" trial requirement.			

I CERTIFY that I am the actual owner of this dog, or that I am the duly authorized agent of the actual owner whose name I have entered above. In consideration of the acceptance of this entry and the opportunity to have this dog judged and to win prize money, ribbons, or trophies, I (we) agree to abide by the rules and regulations of the American Sighthound Field Association in effect at the time of this lure field trial, and by any additional rules and regulations appearing in the premium list for this lure field trial. I (we) agree that the club holding this lure field trial has the right to refuse this entry for cause, which the club shall deem to be sufficient. I (we) agree to hold this club, its members, directors, governors, officers, agents or other functionaries, any employees of the aforementioned parties and the owner(s) of the trial premises or grounds harmless from any claim for loss or injury which may be alleged to have been caused directly or indirectly to any person or thing by the act of this dog while in or upon the lure field trial premises or grounds or near any entrance thereto and I (we) personally assume all responsibility and liability for any such claim, and I (we) further agree to hold the aforementioned parties harmless from any claim loss of this dog by disappearance, theft damage or injury be caused or alleged to be caused by the negligence of the club or any of the aforementioned parties or by the negligence of any person or any other cause or causes. I (we) certify and represent that the dog entered is not a hazard to person or other dogs. This entry is submitted for acceptance of the forgoing representations and agreements.

SIGNATURE of owner or his agent
duly authorized to make this entry _____

Please separate the entries before submitting to FTS.

**OFFICIAL AMERICAN SIGHTHOUND FIELD ASSOCIATION ENTRY FORM
2019 ASFA Region 3 Invitational**

November 17, 2019

Early entries close Tues. November 6, 2019 at 5:00 p.m.

\$22.00 for 1st dog, \$19.00 ea. add'l dog same owner. \$10.00 Non-Regular Stakes

Day of Trial entries close at Roll Call on the day of the trial, \$30.00 per dog.

Make checks payable in US funds to RMIWA and mail with entry to:

Shawna Stone 6620 Finecrest Dr, Colorado Springs, CO 80923

Fee Paid _____ The Field Secretary cannot accept conditional, unsigned, incomplete or unpaid entries; please check your completed entry carefully.

Breed:		Call Name:	
Registered Name of Hound:			
Stake: <input type="checkbox"/> Open <input type="checkbox"/> FCH <input type="checkbox"/> Veteran <input type="checkbox"/> Single <input type="checkbox"/> Limited		Additional Stakes <input type="checkbox"/> Kennel <input type="checkbox"/> Breeder <input type="checkbox"/> Bench	
Registration Number: (please write in registering body before number)			
<input type="checkbox"/> If possible, please separate my hounds		Date of Birth:	Sex: <input type="checkbox"/> Dog <input type="checkbox"/> Bitch
Name of actual owner(s):			
Address:		Phone:	
City:		State:	Zip:
E-mail (Optional)		(Optional) Region of Residence:	
Emergency Contact Name and Phone (Optional)			
<input type="checkbox"/> Check if this is the first ASFA trial for this hound. Attach a Hound Certification or waiver if entered in Open, Veterans, Limited.			
<input type="checkbox"/> Check if this is a first-time entry, a copy of the official Registration of this hound must accompany this entry unless NGA.			
<input type="checkbox"/> Check if any information has changed since the last ASFA trial entry. Regarding _____			
<input type="checkbox"/> Check if this hound has been dismissed within the last 6 trials entered. Must be marked in order to qualify for a "clean" trial requirement.			

I CERTIFY that I am the actual owner of this dog, or that I am the duly authorized agent of the actual owner whose name I have entered above. In consideration of the acceptance of this entry and the opportunity to have this dog judged and to win prize money, ribbons, or trophies, I (we) agree to abide by the rules and regulations of the American Sighthound Field Association in effect at the time of this lure field trial, and by any additional rules and regulations appearing in the premium list for this lure field trial. I (we) agree that the club holding this lure field trial has the right to refuse this entry for cause, which the club shall deem to be sufficient. I (we) agree to hold this club, its members, directors, governors, officers, agents or other functionaries, any employees of the aforementioned parties and the owner(s) of the trial premises or grounds harmless from any claim for loss or injury which may be alleged to have been caused directly or indirectly to any person or thing by the act of this dog while in or upon the lure field trial premises or grounds or near any entrance thereto and I (we) personally assume all responsibility and liability for any such claim, and I (we) further agree to hold the aforementioned parties harmless from any claim loss of this dog by disappearance, theft damage or injury be caused or alleged to be caused by the negligence of the club or any of the aforementioned parties or by the negligence of any person or any other cause or causes. I (we) certify and represent that the dog entered is not a hazard to person or other dogs. This entry is submitted for acceptance of the forgoing representations and agreements.

SIGNATURE of owner or his agent
duly authorized to make this entry _____

Please separate the entries before submitting to FTS.

**AMERICAN SIGHTHOUND FIELD ASSOCIATION
HOUND CERTIFICATION**

Rule effective October 1, 1994: Ch. V, Sec. 4 (a) OPEN STAKE: *To be eligible to enter the open stake, a hound must have been certified by a licensed judge within the year preceding the closing date for the entry or have previously competed in the Open Stake.* This eligibility requirement also applies to a hound entered in the Limited or Veteran Stake, which has not competed in Open previously. Please complete this portion of this form and attach it to the entry form for the hound's first entry, including an entry for a Fun Trial.

Registered Name of Hound: _____

Registration Number: _____ Breed: _____

Registered Owner's Name: _____

I hereby certify that on (date) _____, the above named hound completed a lure course of at least 500 yards, running with another hound of the same breed (or another breed with a similar running style). During the course the above named hound showed no inclination to interfere with the other hound. I further certify that I am a licensed judge for the ASFA.

Name of Licensed Judge: _____

Signature: _____ Date: _____

I hereby certify that the hound running in the certification course is the hound identified above and that information provided on this form is true and correct.

Signature: _____ Date: _____

Owner or Authorized Agent of Hound

This certification form must be attached to the entry form the first time this hound is entered in an open, limited, or veteran stake. Any hound entered in open, limited, or veteran (as a first time entered hound), which has not been certified, shall be declared ineligible by the records coordinator and shall forfeit any points and placements awarded.

PLEASE RETAIN A COPY FOR YOUR RECORDS.

**AMERICAN SIGHTHOUND FIELD ASSOCIATION
HOUND CERTIFICATION WAIVER**

Waiver of Requirement: *This requirement will be waived for a hound that has earned a lure coursing or racing title from another recognized organization, if such title requires competition, and if a waiver for such title has been approved by the ASFA, or a CKC Hound Certification Form. If your hound qualifies for a waiver, complete this portion of this form and attach it to your entry form. Proof of waivers must accompany this certification form.*

Registered Name of Hound: _____

Registration Number: _____ Breed: _____

Registered Owner's Name: _____

CKC: FCH FCHX

AKC: QC SC FC

Hound Certification previously submitted.

I hereby certify that the hound identified above has completed the requirements for the title indicated above (or that the required Certification was previously submitted) and that the information provided on this form is true and correct.

Signature: _____ Date: _____

Owner or Authorized Agent of Hound

**AMERICAN SIGHTHOUND FIELD ASSOCIATION
HOUND CERTIFICATION**

Rule effective October 1, 1994: Ch. V, Sec. 4 (a) OPEN STAKE: *To be eligible to enter the open stake, a hound must have been certified by a licensed judge within the year preceding the closing date for the entry or have previously competed in the Open Stake.* This eligibility requirement also applies to a hound entered in the Limited or Veteran Stake, which has not competed in Open previously. Please complete this portion of this form and attach it to the entry form for the hound's first entry, including an entry for a Fun Trial.

Registered Name of Hound: _____

Registration Number: _____ Breed: _____

Registered Owner's Name: _____

I hereby certify that on (date) _____, the above named hound completed a lure course of at least 500 yards, running with another hound of the same breed (or another breed with a similar running style). During the course the above named hound showed no inclination to interfere with the other hound. I further certify that I am a licensed judge for the ASFA.

Name of Licensed Judge: _____

Signature: _____ Date: _____

I hereby certify that the hound running in the certification course is the hound identified above and that information provided on this form is true and correct.

Signature: _____ Date: _____

Owner or Authorized Agent of Hound

This certification form must be attached to the entry form the first time this hound is entered in an open, limited, or veteran stake. Any hound entered in open, limited, or veteran (as a first time entered hound), which has not been certified, shall be declared ineligible by the records coordinator and shall forfeit any points and placements awarded.

PLEASE RETAIN A COPY FOR YOUR RECORDS.

**AMERICAN SIGHTHOUND FIELD ASSOCIATION
HOUND CERTIFICATION WAIVER**

Waiver of Requirement: *This requirement will be waived for a hound that has earned a lure coursing or racing title from another recognized organization, if such title requires competition, and if a waiver for such title has been approved by the ASFA, or a CKC Hound Certification Form. If your hound qualifies for a waiver, complete this portion of this form and attach it to your entry form. Proof of waivers must accompany this certification form.*

Registered Name of Hound: _____

Registration Number: _____ Breed: _____

Registered Owner's Name: _____

CKC: FCH FCHX

AKC: QC SC FC

Hound Certification previously submitted.

I hereby certify that the hound identified above has completed the requirements for the title indicated above (or that the required Certification was previously submitted) and that the information provided on this form is true and correct.

Signature: _____ Date: _____

Owner or Authorized Agent of Hound